

Special Swivel – Ball Bearing JDT

Produktinformation



ENORM 10 lifting accessories are characterised by their high strength alongside increased toughness and an above average resistance to extreme temperatures. ENORM 10 products meet the requirements of the PAS 1061

For chain slings EN 818-4 and suitable for all clevis heads of JDT-Assembling-System

... [Read more](#)

Märkning: Enligt standard

Standard: EN 1677-1

Säkerhetsfaktor: 4:1

Klass: 10

Special Swivel – Ball Bearing JDT

Ritning & mått

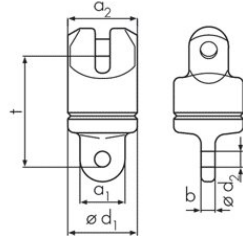

Lyfttabell

| Art.nr | Benämning | Max last (WLL) ton | a1mm mm | a2mm mm | b mm | Ø d1 mm mm | Ø d2 mm mm | t mm | Vikt kg |
|----------|---------------|-----------------------|---------|---------|------|------------|------------|------|------------|
| LEIK6SH | ENORM EWGO 6 | 1,4 | 20 | 36 | 6 | 36 | 7,7 | 51 | 0,26 |
| LEIK8SH | ENORM EWGO 8 | 2,5 | 26 | 43 | 8 | 41 | 10,6 | 56 | 0,41 |
| LEIK10SH | ENORM EWGO 10 | 4 | 35 | 52 | 10 | 51 | 13,2 | 73 | 0,86 |
| LEIK13SH | ENORM EWGO 13 | 6,7 | 43 | 65 | 13 | 59 | 17 | 88 | 1,51 |