

Beam clamps

Produktinformation

The clamp can be used for example to attach a hoist to an I or T beam ... [Read more](#)

Märkning: Enligt standard, CE-märkning

Standard: EN 13155

Säkerhetsfaktor: 4:1



Beam clamps

Ritning & mått

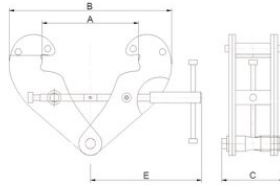

Lyfttabell

Art.nr	Max last (WLL) ton	Beam width	A mm	B mm	C mm	E mm	Vikt kg
TARPAL10	1	75-220	75-260	180-360	64	215	3,8
TARPAL20	2	75-220	75-260	180-3360	74	215	4,6
TARPAL30	3	80-320	80-354	235-490	103	260	9
TARPAL50	5	80-320	90-354	235-490	110	260	11
TARPAL100	10	90-320	80-365	320-505	120	260	16