

Marine C5M Hand Winch MR3000-5000

Product information



Robust marine winch has a high corrosion resistance due to its many 316 stainless steel parts and 3 layers of C5M offshore coating. The hand winch is IP54 standardised which means that it is resistant to splash water and dust on the inside.

- Load pressure brake with double ratchet system for safe stable hold of the load in any position
- Closed gearbox to protect against environmental influence - protection classification IP54
- Cable outlet upwards, downwards or at rear
- Adjustable crank
- Suitable for wall and (optional) floor mounting
- Brushed steel frame with marine coating DIN/ISO 12944 C5M - RAL9005 (black)
- Stainless steel 316 parts: drum, crank and all outgoing shafts, bolts and nuts
- Corrosion resistant

Options:

- Grooved drum (GD)
- 2 drum compartment (2D) or multiple up to 8 (XD)
- Suitable for floor mounting (FM)
- Suitable for Dyneema rope (DY)
- Pressure roller (PR)
- ATEX certified zone 2 and 22 (EX)
CE II 3G Ex IIC T4 Gc, -20°C<T amb <+70°C

[... Read more](#)

Material: Steel, stainless steel

Marking: According to standard, CE-marked

Finish: Paint thickness is 240 micron in 3 layers

Standard: EN 13157

Note: Steel, stainless steel or fiber ropes must be ordered separately

Safety factor: 4:1

Marine C5M Hand Winch MR3000-5000

Blueprint

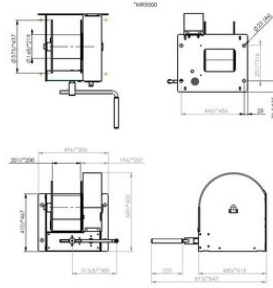

Technical data / Spare Parts

Part code	WLL ton	Model	Rope Ø mm	Rope capacity m	Weight kg
MR3000	3	MR3000 C5M	14	68.7	104
MR5000	5	MR5000 C5M	18	42.9	135