

Stainless steel connecting link

Product information

Connecting link is used for connecting short link chains to different components in a lifting sling.

... [Read more](#)



Material: AISI 316

Marking: CE-marked

Temperature range: -40 - (+)400°C

Warning: Not to be heat-treated

Safety factor: 4:1

Stainless steel connecting link

Blueprint

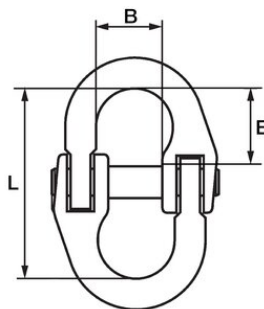

Technical data / Spare Parts

Part code	WLL ton	For chain Ø mm	E mm	B mm	L mm	Weight kg
LLHK6	0.7	6	14	16	45	0.1
LLHK8	1.2	8	18	20	55	0.16
LLHK10	1.6	10	25	25	73	0.36
LLHK13	2.7	13	32	28	92	0.73