

## Pulleys, double

---

### Product information

Pulley is suitable for synthetic fibre ropes.

... [Read more](#)

---



**Material:** Frame: cast zinc | Surface treatment: electro-galvanizing | Roll: Nylon

**Warning:** Not for lifting

## Pulleys, double

Blueprint

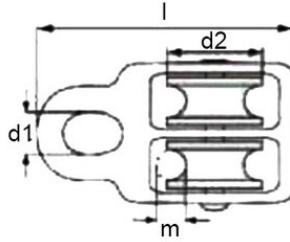

### Technical data / Spare Parts

Part code	Breaking Load ton	Rope Ø range mm	d1 mm	d2 mm	l mm
PYL205	0.18	5	10	15	50
PYL206	0.2	6	11	20	60
PYL208	0.25	8	13	30	80
PYL209	0.3	9	14	40	93
PYL212	0.4	12	16	50	113