

Stainless steel lifting eye screw DIN 580

Product information

Stainless steel lifting eye for vertical lifting.

[... Read more](#)



Material: AISI 316

Marking: According to standard, CE-marked

Temperature range: -40°C - (+)200°C

Finish: Polished

Standard: DIN 580

Note: Only for vertical lifting

Warning: Not to be heat-treated

Safety factor: 4:1

Stainless steel lifting eye screw DIN 580

Blueprint

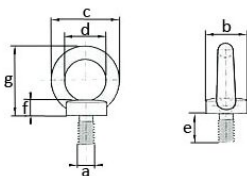

Technical data / Spare Parts

Part code	WLL ton	Thread mm	b mm	c mm	d mm	e mm	f mm	g mm	Weight kg
NSRH06L	0.075	M6	20	36	20	13	6	36	0.06
NSRH08L	0.14	M8	20	36	20	13	6	36	0.06
NSRH10L	0.23	M10	25	45	25	17	8	45	0.11
NSRH12L	0.34	M12	30	54	30	20.5	10	53	0.18
NSRH16L	0.7	M16	35	63	35	27	12	62	0.28
NSRH20L	1.2	M20	39	71	39	30	14	70	0.45

WORKIN LOAD LIMITS

Thread	WLL (t)	WLL (t)	WLL (t)	WLL (t)	WLL (t)	WLL (t)	WLL (t)	WLL (t)
					0 - 45°	45-60°	0 - 45°	45-60°
M6	0,08		0,16		-		-	
M8	0,14		0,28		0,1		0,14	
M10	0,23		0,46					