

Special Swivel – Ball Bearing JDT

Product information



ENORM 10 lifting accessories are characterised by their high strength alongside increased toughness and an above average resistance to extreme temperatures. ENORM 10 products meet the requirements of the PAS 1061

For chain slings EN 818-4 and suitable for all clevis heads of JDT-Assembling-System

[... Read more](#)

Marking: According to standard

Temperature range: - 40 °C to 200 °C 100 %, 200 °C to 300 °C 90 %, 300 °C to 400 °C 75 %

Standard: EN 1677-1

Safety factor: 4:1

Grade: 10

Special Swivel – Ball Bearing JDT

Blueprint

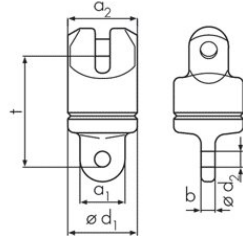

Technical data / Spare Parts

Part code	Code	WLL ton	a1mm mm	a2mm mm	b mm	Ø d1 mm mm	Ø d2 mm mm	t mm	Weight kg
LEIK6SH	ENORM EWGO 6	1.4	20	36	6	36	7.7	51	0.26
LEIK8SH	ENORM EWGO 8	2.5	26	43	8	41	10.6	56	0.41
LEIK10SH	ENORM EWGO 10	4	35	52	10	51	13.2	73	0.86
LEIK13SH	ENORM EWGO 13	6.7	43	65	13	59	17	88	1.51