

Excavator hook, weldable, grade 80

Product information

Weld-on excavator hook for excavator dippers, work machines and vehicles.

[... Read more](#)



Material: Steel

Marking: According to standard, CE-marked

Temperature range: -40 - (+)200°C / 400°C = WLL 75%

Finish: Painted, yellow

Standard: EN 1677-1

Safety factor: 4:1

Grade: 8

Excavator hook, weldable, grade 80

Blueprint

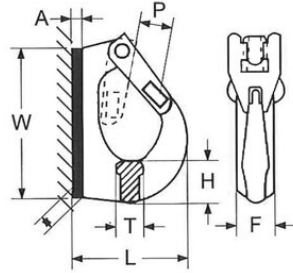

Technical data / Spare Parts

Part code	WLL ton	A mm	W mm	P mm	T mm	L mm	H mm	F mm	Weight kg
KAKO02	2	5	80	25	20	94	24	34	0.8
KAKO03	3	6	115	30	24	105	30	36	1.2
KAKO05	5	10	155	34	28	132	43	44	2.5
KAKO08	8	12	160	34	38	135	51	51	3.3
KAKO10	10	15	200	50	39	167	55	53	5.2
KAKO15	16	14	241	54	45	184	67	61	7.9

Excavator hook, weldable, grade 80

SPARE PARTS

There are two different hook models in the range; check the information on the hook.

MODEL 1 Spare part set

Character and/or digit combination, e.g. CDY, WG8 or K5MF

Spare part (product code)	Description	Fit for hooks (product code/-s)
KAKOKOR02	Incl. latch, spring and pins	KAKO02, KAKO03
KAKOKOR05	Incl. latch, spring and pins	KAKO05, KAKO08
KAKOKOR10	Incl. latch, spring and pins	KAKO10

MODEL 2 Spare part set

4-digit combination, e.g. 2412 (year/month)

Spare part (product code)	Description	Fit for hooks (product code/-s)
KAKOKOR02H	Incl. latch, spring and pins	KAKO02
KAKOKOR03H	Incl. latch, spring and pins	KAKO03
KAKOKOR05H	Incl. latch, spring and pins	KAKO05 & KAKO08
KAKOKOR10H	Incl. latch, spring and pins	KAKO10
KAKOKOR15H	Incl. latch, spring and pins	KAKO15 (16 t model)

Note: If you have problems with batch identification, please consult the supplier