

Steel wire rope winches with side handle

Product information



Steel wire rope winch for lifting and pulling. Equipped with a two way friction brake. The winch can be attached in many different ways to e.g. wall or floor.

Product is delivered without steel wire rope which can be ordered separately.

WIRE ROPES WITH SWIVEL LATCH HOOK

Suits for winch	Length	Wire diameter	Product code
VAVIN150 / VAVIN250	12 m	4 mm	VAVIN250VA412
VAVIN500	14 m	6 mm	VAVIN500VA614
VAVIN1000	30 m	10 mm	VAVIN100VA1030
VAVIN2000	30 m	13 mm	VAVIN200VA1330

... [Read more](#)

Material: Steel

Marking: According to standard, CE-marked

Standard: EN 13157

Steel wire rope winches with side handle

Blueprint

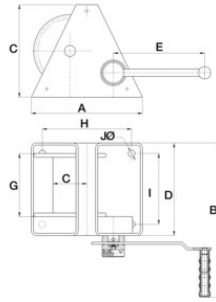

Technical data / Spare Parts

Part code	WLL ton	Rope Ø mm	Max. pulling capacity kg	Gear ratio	Rope capacity m	A mm	B mm	C mm	D mm	E mm	G mm	H mm	I mm	JØ mm	Weight kg
VAVIN150	0.075	4	150	2,84:1	22	180	325	150	150	350	102	152	112.5	9	5.5
VAVIN250	0.15	4-5	300	6,67:1	40	240	385	200	200	250	122	196	143	13	16.9
VAVIN500	0.25	6	500	7,75:1	20	240	385	200	200	250	122	200	145	13	18.8
VAVIN1000	0.5	9-10	1,000	23,75:1	30	412	485	300	300	350	195	367	235	17	38
VAVIN2000	1	13	2,000	43,7:1	30	500	585	325	405	350	285	436	326	21	68.4